

# Salmo River







**Regional District of  
Central Kootenay**

### DATA SOURCES

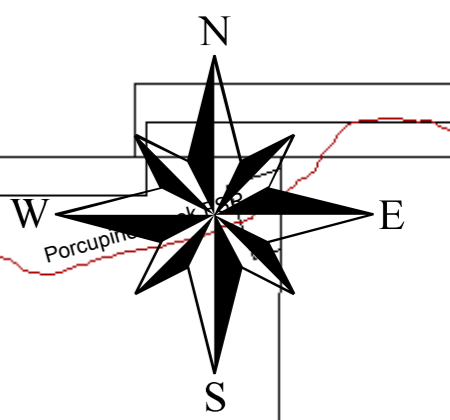
The following sources of data are updated as changes occur:  
Cadastral Lot - Surveyed lots/parcels of land; Source: Crown Land Registry Services and RDCK  
District Lot: Source: Crown Land Registry Services, Integrated Cadastral Initiative (CI) and RDCK  
TRIM Data - Planimetry, Unsurveyed Roads, and Contours; Source: Ministry of Water, Land and Air Protection  
Roads - Road centerline compiled 2003; Source: RDCK  
Sheep Creek and Clear Water Flood Study Areas; BGC Engineering (2019)  
Regional District of Central Kootenay  
Box 590, 250 Lakeside Drive, Nelson,  
BC V1J 5R4  
Phone: (250) 352-5665  
Toll-Free 1-800-268-7325 (BC)  
Fax: (250) 352-9300 Internet: www.rdck.bc.ca

Map Projection: UTM Zone 11  
Map Datum: NAD83  
Date: 6/14/2019  
2  
1 Km



-  Lakes and Rivers
-  Clear Water Flood Study Area
-  Roads
-  Lot Lines

